

Durra Wall System

INTRODUCTION

The Durra Wall System is an exciting new development for internal wall construction that can be adapted to suit the majority of design requirements. It is easy and clean to install and when erected provides a strong, durable wall that combines the benefits of a dry, lightweight system with the practicalities of traditional finishes, at a remarkably competitive price.

The revolutionary approach combines our proven methods and established manufacturing techniques with additional emphasis on simplicity, strength, acoustic performance and speed of installation, as well as economy and flexibility of designs.

PRODUCT FEATURES

- Environmentally Friendly
- Acoustic Performance
- Quality
- Fire Resistance
- Impact Resistant
- Thermal Insulation
- Simple Construction
- Reduced Labour Time
- Cost Saving
- Strength & Durability
- Flexible Design Solutions



IMPACT RESISTANCE

The benefits of using Durra Panel have been demonstrated by a CSIRO comparative impact test of it against plasterboard.

The testing involved dropping a 100mm diameter 3.62 kg cast iron ball on the products from a range of heights.

When dropped from 2.7m onto a Durra panel, the result was a dent of just 4mm with minimal fracturing of the paper liner, confirming it is 10 times more impact resistant than conventional plasterboard.

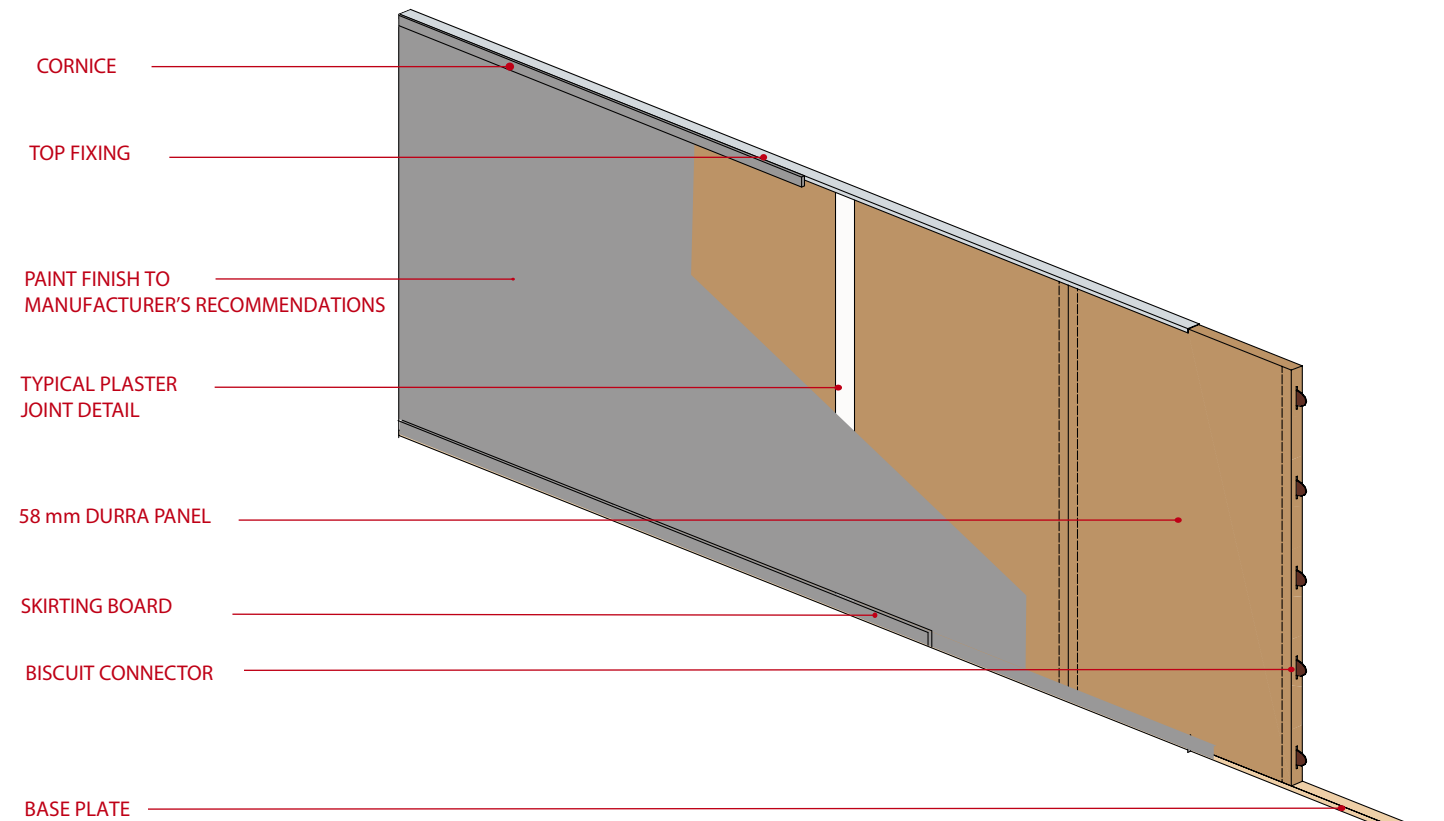

MANUFACTURING AND INSTALLATION

The Durra Panel T58, manufactured with a combination of extreme heat and compression in our exclusive dry extrusion process, features tapered long edges and a unique mechanical linking concept – our patented Biscuit Connection System.

This simple but effective connection system locates and secures the wall panels together at vertical panel-to-panel joints. Each panel has two 25mm diameter conduit holes for ease of running electrical and data services inside the solid wall.

The Durra Panel production process is environmentally sound, densely compressing a largely wasted resource - wheat or rice straw fibre - into construction panels. No chemical binding agents are used in this unique manufacturing process which leaves zero toxic waste.



DURRA PANEL CROSS SECTION

PRODUCT FINISHING

Following installation of the panels, a skim coat of plaster is simply applied to all vertical joints between boards and abutments. We recommend a standard GB 100 plaster jointing system for good results.

The Durra Panel can be painted, plastered, or wallpapered, depending upon your project requirements. It is self supporting between top and bottom fixings for heights up to a recommended 2700mm, without the need for additional framing.

After completion of the Durra Wall, architraves and skirting boards can be fixed into place.



ENVIRONMENTAL PROTECTION AGENCY (EPA)